

FIRE FACT NO. 057 CHECKLIST(s) :

Rev. 11/2006

TITLE : CHILD CARE HOMES

CHECKLIST ITEM(s) :

REFERENCE(s) : K.S.A. 31-133

PAGE 1 of 5

FIRE FACT 057 CHILD CARE HOMES

The role of the Kansas State Fire Marshal is to insure that all providers of child care homes are prepared in the event of a fire emergency. There are over 5,000 structure fires each year in Kansas. Over 70% of those fires and 75% of the fire deaths that result happen in homes. This is why fire safety awareness is so important. **BIG FIRES START SMALL.** In less than four minutes a small waste paper basket fire can spread throughout the average home, causing enough smoke to keep everyone inside from being able to get out safely. Smoke is the main killer in a fire because of the toxic gases that are released from the burning materials. Smoke will disable you before the flames ever reach you. In a fire, seconds count.

As a child care provider, you accept legal responsibility for providing a fire-safe home for everyone in your care. You are ensuring that everyone can be evacuated from your home to a safe place outside of the home in the event of a fire. More information on owner and operator responsibility can be found in Fire Fact 004.

Kansas State Fire Marshal Requirements for Child Care Homes

- **Care is provided in a structure designed and used as a one or two family dwelling.** If care is being provided in a church, school, commercial building, or anything else that is not a home, the requirements for childcare centers or preschools must apply. See Fire Fact 050.
- **Provide two separate escape routes from all areas in your home where children are cared for.** These escape routes should lead to a place of safety outside your home. The exits must allow you and all other occupants to safely get out of your home within four minutes, and the exit paths must not lead through garages, storage rooms, or other hazardous rooms. It is your responsibility as the provider to check these exits daily to ensure they are operable and accessible.

Main Floor Exiting Requirements: One exit must be easily walked to and lead directly to the outside. The second exit must allow you to walk or crawl directly to the outside. This second exit may be a compliant rescue/ventilation window, as described in Fire Fact 023. Whether the second exit is a rescue/ventilation window or a door, the exit path must continue to ground level.

Basement Exiting Requirements: If your basement will be used for child care, two separate exit paths must be provided. One exit will be stairs leading back to the main floor. The second exit may be another set of compliant stairs leading to the main level, a rescue/ventilation window to the outside, or a door that leads directly outside and continues to ground level. Any window used for exiting must meet the requirements found in Fire Fact 023.



Kansas State Fire Marshal Prevention Division

FIRE FACT NO. 057 CHECKLIST(s) :

TITLE : CHILD CARE HOMES

CHECKLIST ITEM(s) :

REFERENCE(s) : K.S.A. 31-133

PAGE 2 of 5

Second Floor Exiting Requirements: Second floors, if used for child care, must have two separate exits from the floor. One exit will be stairs leading back to the main floor. The second exit may be another set of compliant stairs leading to the main level or a door or rescue/ventilation window that leads directly outside and continues to ground level with compliant stairs. Ladders of any type from a second floor window are not acceptable. Childcare can not be located above the second floor.

- **Install working smoke detectors on every level of your home and maintain them according to manufacturer's directions.** See Fire Fact 036 for information on types of smoke detectors. The smoke detectors must be powered by the home's electrical supply or by 10-year lithium batteries. They must be located in every exit pathway and in each sleeping room used for children in your care. Regardless of how they are powered, the smoke detectors must be tested monthly. The tests must be recorded and documentation kept on file.
- **Children must be able to open every closet door from the inside at all times.** For closets containing household cleansers, chemicals, or other items dangerous to children, hook-and-eye closures at the top of the closet door will be permitted, as long as children are unable to access the closure.
- **Bathroom doors must be able to be unlocked from the outside at all times.** An unlocking device for the bathroom door should be readily accessible to the provider.
- **Emergency procedures must be written down and practiced.** Fire drills must be done monthly and documented, and the evacuation time must be less than four minutes. Tornado drills must be practiced monthly April through September and documented. Practice fire and tornado drills at different times of the day, regardless of weather, so that in the event of a real emergency you will be prepared to get everyone in your care to a place of safety.

Conducting a fire drill:

- 1) Use the test button on your smoke detector to sound the alarm.
- 2) Be able to account for all those in your care at all times.
- 3) Keep anyone from re-entering the home or being injured by an outdoor hazard.
- 4) Once you get everyone to the place of safety, make a note of the elapsed time and record it and the other requested information on your Tornado and Fire Drill Record.

In an actual emergency, always call the fire department from a neighbor's home after everyone in your care is out of your home. Then allow the trained emergency personnel to do their job. Never reenter a burning home to try to extinguish the fire.



Kansas State Fire Marshal Prevention Division

FIRE FACT NO. 057 CHECKLIST(s) :

TITLE : CHILD CARE HOMES

CHECKLIST ITEM(s) :

REFERENCE(s) : K.S.A. 31-133

PAGE 3 of 5

- **A copy of the Fire/Life Safety Agreement must be posted next to your license.**
- **All unused electrical outlets in the area to be licensed have child-resistant protective covers.**
- **All natural gas, kerosene, wood, propane heaters, etc., are properly vented to the outside of the home.** Unvented heaters are acceptable, but if the heater was designed by the manufacturer to be vented to the outside, it must be properly vented.
- **Barriers protect children from all heating devices.** The barriers should prevent the children from getting too close or being burned. This applies to fireplaces, both wood- and gas-fueled.
- **Contact your local fire department or building and zoning officials about any local requirements for home child care providers.** You must meet these requirements. Remember that your local emergency service providers are the ones who respond to your emergencies. They are your partners in protecting the lives of the children in your care.
- **You must follow the Kansas Department of Health and Environment Child Care licensing and registration requirements to protect the children in your care from other hazards.**

Additional resources:

Fire Fact 004 – Owner/Operator Responsibility

Fire Fact 023 – Escape Windows

Fire Fact 036 – Smoke Detection



Kansas State Fire Marshal Prevention Division

FIRE FACT NO. 057 CHECKLIST(s) :

TITLE : CHILD CARE HOMES

CHECKLIST ITEM(s) :

REFERENCE(s) : K.S.A. 31-133

PAGE 4 of 5

MEANS OF ESCAPE BASEMENT-DIRECT TO GROUND LEVEL PREFERRED

8 feet vertical travel (maximum)

Guardrail 42 inches tall with intermediate bars at 4 inches on center

Designated meeting place

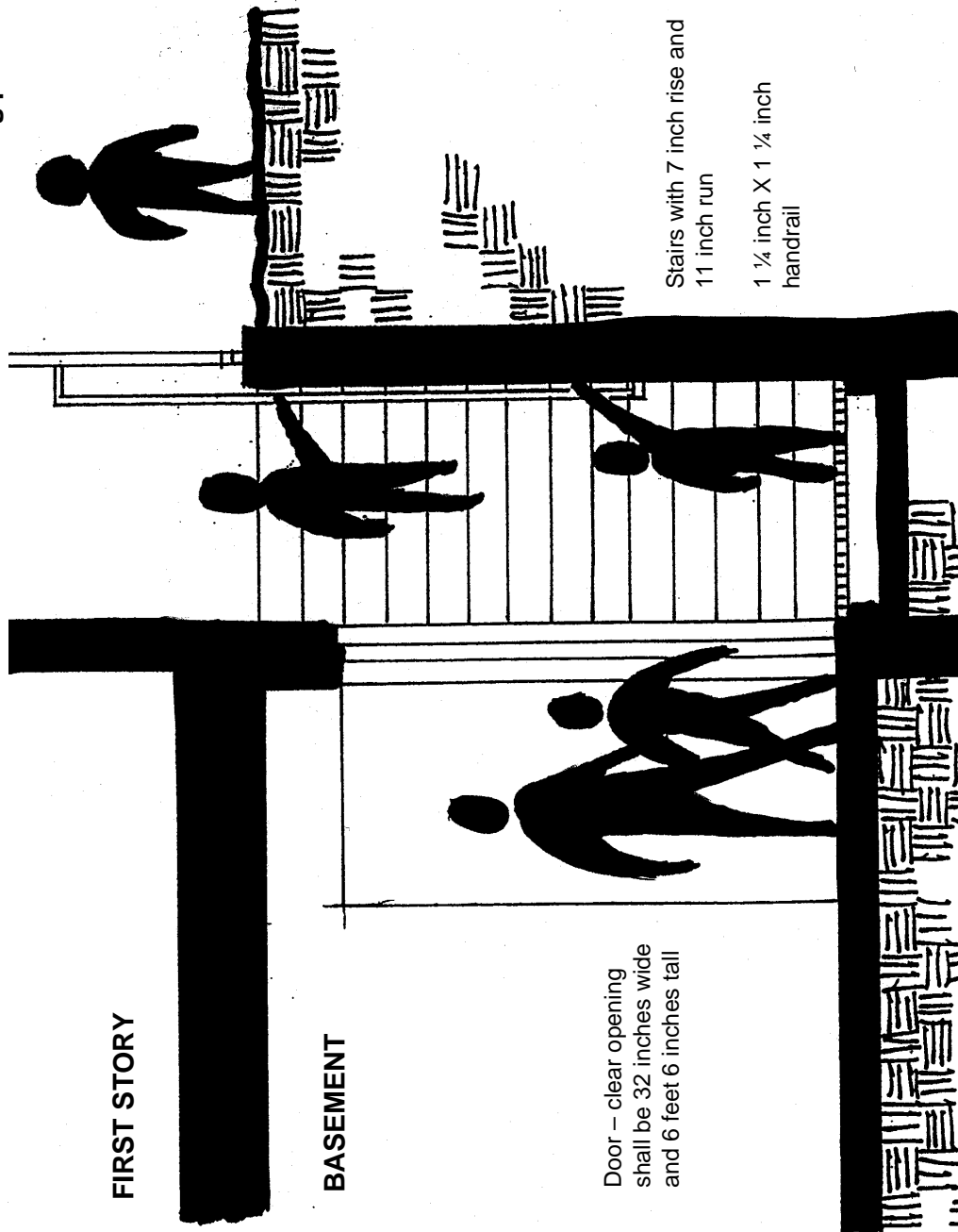

FIRST STORY

BASEMENT

Door - clear opening shall be 32 inches wide and 6 feet 6 inches tall

Stairs with 7 inch rise and 11 inch run

1 1/4 inch X 1 1/4 inch handrail



Kansas State Fire Marshal Prevention Division

FIRE FACT NO. 057 CHECKLIST(s) :

TITLE : CHILD CARE HOMES

CHECKLIST ITEM(s) :

REFERENCE(s) : K.S.A. 31-133

PAGE 5 of 5

The door pictured below is not approved as an acceptable exit from a basement. This type of door is subject to snow loads, falling debris, and being locked, blocked, or vandalized in some manner.

Children attempting to evacuate this lower level space may not be able to operate the locking arrangement and the door may be too heavy to push to initiate the spring assists.

Any approved exit from a basement shall lead directly to grade level. Any provisions for weather protection shall meet height and width requirements for a standard exit door. A person shall be able to walk up to the door operate the latching device and exit the building. The only exceptions to this are explained in Fire Fact 023.

